

# CORNER RESTORATION

**CORNER:** E1/4 Cor. Sec. 11 Twp. 13 S. Range 33 E., W.M.

**ORIGINAL SURVEY BY:** John B. David

**SURVEY NUMBER:** 131

**CONTRACT DATE:** June 8, 1869

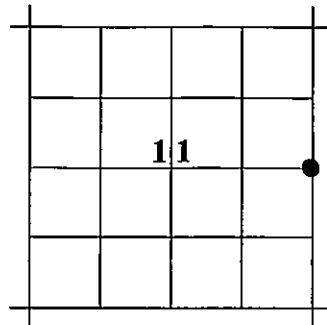

**Subsequently remonumented:** November 26, 1976 by Robert Bagett, County Surveyor, see Record Map of Survey No. 422

**ORIGINAL G.L.O. DESCRIPTION:** *Set Stone 17x9x7 for 1/4 Sec. corner,*  
**Bagett's 1976 description from Map of Survey No. 422:** *At the East 1/4 Cor. Fd. Orig. Mkd. Stone & 3/8" Iron Pipe Set in Fence Cor. Set G.C.S. Brass Cap.*

**EVIDENCE FOUND:** Found a 1½" iron pipe with attached 2½" brass cap attached, marked as shown below. The monument is in good condition at the corner of fences running North, South and West.

From which, I SET THE FOLLOWING REFERENCE POINTS:

- ▶ A 5/8"x30" iron pin bears N.00°32'E., 23.34 ft., with attached alum. cap marked GRANT COUNTY SURVEYOR RP 1 2011
- ▶ A 5/8"x30" iron pin bears N.88°18'E., 35.70 ft., with attached alum. cap marked GRANT COUNTY SURVEYOR RP 2 2011
- ▶ A 5/8"x30" iron pin bears S.01°06'E., 26.33 ft., with attached alum. cap marked GRANT COUNTY SURVEYOR RP 3 2011
- ▶ A 5/8"x30" iron pin bears N.87°24'W., 40.71 ft., with attached alum. cap marked GRANT COUNTY SURVEYOR RP 4 2011

**STATE PLANE COORDINATES (3601 OR N)**  
Reference Datum: NAD83 From OPUS Solution

Northing: 292,178.7 ft.  
Easting: 8,673,123.4 ft.  
Ellip. Ht: 3,546.2 ft.

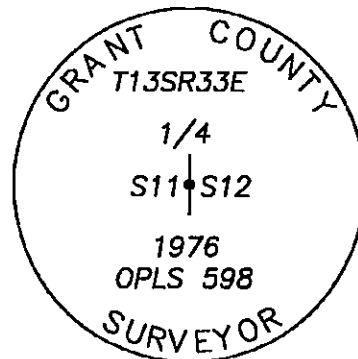

**RESTORATION BY, STAMP AND DATE:**

Michael C. Springer, Grant County Surveyor  
Jason L. Hatfield, Deputy County Surveyor

RECEIVED AND FILED  
GRANT COUNTY SURVEYOR

Surveyed March 3, 2011  
and November 17, 2011

NOV 21, 2011

BY 



EXPIRES: 6/30/2012